

ES LINEAR ACTUATOR F/A - CONFIGURATION M601

UP TO **86 kN** **Tr** **KGS BALLS**
TRAPEZ.



Motoreducer at 90°

There is a large range of reductions available for the M601 configuration.

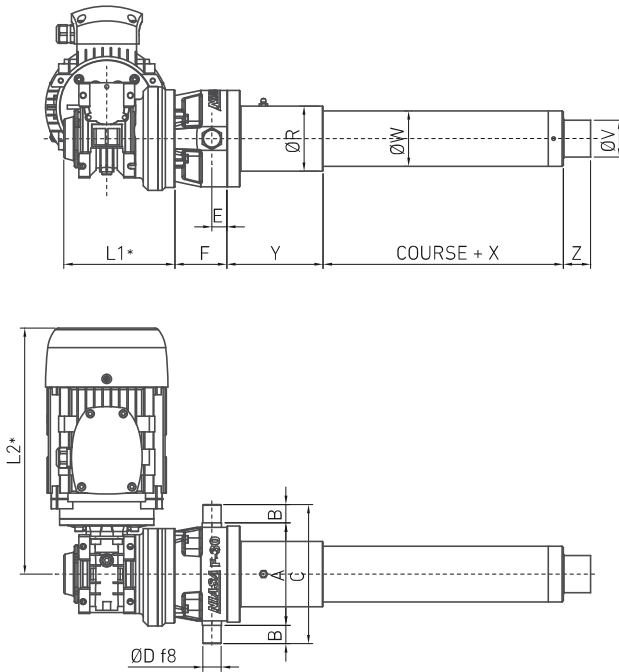

Maximum axial strength

	Diameter and pitch screw (mm)	Load (kN)
F20 / A20	Tr 24x5	9.5
	KGS 2005	10.5
	KGS 2020	5.5
F30 / A30	Tr 36x6	15
	KGS 3205	21.5
	KGS 3210	23.5
	KGS 3220	12
	KGS 3240	6
F40 / A40	Tr 45x7	22
	KGS 4010	38
	KGS 4020	21.5
F45	KGS 4040	11
	Tr 50x8	47.5
F50	KGS 5010	78
	Tr 70x10	60.5
	KGS 6310	86

*Depends on the motoreducer selected and the manufacturer.
For further information, please contact the NIASA technical department.

	M601 configuration dimensions						M100 configuration general dimensions						
	A	B	C	ØD f8	E	F	X	Y	Z	ØV	ØW	ØR	More dimensions
F20	116	20	156	20	15	55	106	100	36	35	55	66	Page 80
F30	138	25	188	25	20	70	124	130	37	50	75	88	Page 82
F40	160	40	240	35	30	75	155	150	67	70	90	110	Page 84
F45	200	40	280	40	35	105	175	195	65	90	115	140	Page 86
F50	260	50	360	45	40	130	185	300	95	110	150	196	Page 87

... Contact the NIASA technical department for the different drive possibilities.

... If using ball screws, the actuator is reversible. In general, it is always advisable that the motors have brakes. In most cases, standard brakes for each motor size are sufficient. This will ensure the stem does not when it stops or if there are vibrations, etc.

